

The Times of Tetford and Salmonby

Times present, Times past, Times future

ISSUE NUMBER 46

November 2025



The Three Additional Bells Arrive at St Mary's Tetford at 9.30am on Tuesday 21st October 2025

CONTENTS

Dates for Your Diary

Preface

News Round Up Round the Villages

The Horncastle Quiz - Answers

Feature – The Men on the Tetford War Memorial, by Jonty Wild: Part 11

Group News

Church News

Arts & Culture

Children and School

Clubs, Societies, Activities & Facilities

Tetford & Salmonby Parish Council

NEXT COPY DEADLINE

Friday 5th December 2025 for delivery around the 11th

No issue in January, next issue copy deadline Friday 6th February 2026



HMT
Landscaping
services

Garden maintenance
Grass cutting
Hedge cutting
Tree felling
Chipping
Strimming
Weed control
Garden waste removal
Pressure washing

Based in Tetford covering all surrounding areas.
Call or message for quote or enquiry 07506 774589

• JACK & JILLS MOBILE HAIR STYLIST

• Ladies and Gents

• 13 years' experience

• Tel. 07903 468464 (also can be found on Facebook)



YOU ARE INVITED TO A

CHRISTMAS PARTY

SAT 13TH | FREE | 3 PM -
DEC | ENTRY | 5PM

FAMILY EVENT - REFRESHMENTS -
ENTERTAINMENT - CRAFTS

Hamilton Hall, Tetford,
LN9 6QQ

Call or Text To Book:

07748611903 (Jean

Or Try Jotform:

<https://form.jotform.com/252943309347058>



DATES FOR YOUR DIARY

Horncastle Theatre Company <i>Gaslight</i> , Red Lion Theatre, Horncastle	Wednesday 19 th November to Saturday 22 nd November 7.30pm,
Tea & Chat, Hamilton Hall	Tuesday 25 th November 2-4pm
WI Make a Christmas Wreath, Hamilton Hall	Wednesday 26 th November 7.30pm
Tetford & District Reading Group	Friday 28 th November
Prize Bingo, Belchford Village Hall	Sunday 30 th November 1.15pm
Louth Choral Society, <i>Music for Advent</i> , St James's Louth	Sunday 30 th November 7pm
Tea & Chat, Hamilton Hall	Tuesday 2 nd December 10am
TTOTAS Copy Deadline	Friday 5 th December
Light a Light + Christmas Concert, St Mary's Tetford	Friday 5 th December 6pm + 7pm
Tetford St Mary Informal Service	Sunday 7 th December 10am
Tea & Chat, Hamilton Hall	Tuesday 9 th December 2-4pm
Hagworthingham Christmas Quiz, Hamilton Hall	Friday 12 th December 7.30pm
Horncastle Choral Society, Handel's Messiah, St Mary's Horncastle	Friday 12 th December 7.30pm
Family Christmas Party, Hamilton Hall	Saturday 13 th December 3-5pm
Tea & Chat, Hamilton Hall	Tuesday 16 th December 2-4pm
Access Mobile Delivery>Returns	Thursday 18 th December
Carols at Harrington Hall	Thursday 18 th December 6.30pm
Tea & Chat, Hamilton Hall	Tuesday 23 rd December 2-4pm
Tetford St Mary 9 Lessons & Carols	Wednesday 24 th December 6pm
Tetford St Mary Christmas Day	Thursday 25 th December 10am
Tea & Chat, Hamilton Hall	Tuesday 30 th December 2-4pm
Tetford St Mary Informal Service	Sunday 4 th January 10am
Tea & Chat, Hamilton Hall	Tuesday 6 th January
Tea & Chat, Hamilton Hall	Tuesday 13 th January 2-4pm
Parish Council Monthly Meeting, Hamilton Hall	Wednesday 14 th January 7.30pm
Tea & Chat, Hamilton Hall	Tuesday 20 th January 2-4pm
Tea & Chat, Hamilton Hall	Tuesday 27 th January 2-4pm
WI 'Forensic Science', Hamilton Hall	Wednesday 28 th January 7.30pm
Tetford St Mary Informal Service	Sunday 1 st February 10am
Tea & Chat, Hamilton Hall	Tuesday 3 rd February
Tea & Chat, Hamilton Hall	Tuesday 10 th February 2-4pm
Brinkhill St Philip Evensong	Sunday 15 th February 6pm
Tea & Chat, Hamilton Hall	Tuesday 17 th February 2-4pm
Tea & Chat, Hamilton Hall	Tuesday 24 th February 2-4pm

THE TIMES OF TETFORD & SALMONBY

Welcome to the 46th edition of *The Times of Tetford and Salmonby* (TTOTAS)

The Times of Tetford and Salmonby is an editorially independent ‘news magazine’, all-inclusive, unaffiliated, unsponsored, apolitical, secular, non profit-making, unfunded, uncorrupted and incorruptible, transparent, benign if occasionally irreverent, impartial except when it’s not, answerable only to the residents of Tetford & Salmonby. And in order to ensure maximum inclusivity we deliver free to every household in Tetford and Salmonby and to many in the surrounding villages, complementing the multitude of online local ‘social media’ sites.

~~~~~

**THIS MONTH.** The bells are in! See **David Bennett**’s update on a surprisingly sudden success. **Jim Sutcliffe** uncovers the truth about the Salmonby Bends saga and we have the answers to last month’s Horncastle quiz. Christmas is coming, so lots of news about festive events in Tetford, Horncastle and Louth. A Christmas Party is being organised for families by Jean Batchelor, and also for the younger residents we have the usual tricky quiz plus stories by two budding Booker Prizewinners.

**Donations** £47.60 in donations this month. Total donations (i.e. income) to date £2623.00. Expenditure still outstrips income by about £2000. Further donations please put through the Barley Corn Cottage door (postcode LN9 6QH) or by bank transfer a/c **36053762** sort code **30-99-50** account name **The Times of Tetford & Salmonby**.

**Post** your ideas/essays/letters/rants/poems/news through the letterbox of **Barley Corn (aka Barley) Cottage in North Road** or email to [thetimesoftetford@gmail.com](mailto:thetimesoftetford@gmail.com).

**Suggestions** for front cover images for future issues, **and requests for back issues** please deliver by hand to Barley Corn Cottage, phone 01507 534800 or email [thetimesoftetford@gmail.com](mailto:thetimesoftetford@gmail.com). Back issues can be supplied online (or, if you’re quick, in hardcopy, as we always print a few extra).

**Please continue** to alert us where we print falsehoods, or typos, or any sort of misinformation e.g. if something’s out of date.

**Please keep us up to date** by submitting dates and details of your events **well in advance of our deadlines, around the 10<sup>th</sup> of the month**. And please, please bring us NEWS!

*The Times of Tetford & Salmonby* can be viewed (in more colour) on the Parish Council website <https://tetford.parish.lincolnshire.gov.uk/> Find it under VIEW ALL PARISH INFORMATION.

Disclaimer: Opinions expressed herein are the opinions of the respective authors and do not necessarily reflect the opinion of the Editor, nor do they necessarily reflect the opinions of the members of the delivery team

# NEWS ROUND UP ROUND THE VILLAGES

## TETFORD

### **THE PRIDE OF TETFORD – OUR MEN OF THE FIRST WORLD WAR** – *Jonty Wild*

For anyone interested in the Tetford men who are on the memorial, beyond the articles appearing in this magazine, the full-length versions are now in the church (in a binder with the above title). As new ones are finished, they will be added.

Please don't remove the binder or any of the articles, if you want copies or can add any information to those done or that are in progress, just let me know

[jontywild@byacatswhisker.co.uk](mailto:jontywild@byacatswhisker.co.uk), 01507 534075

**THE HONESTY SHOP** outside the Mansion House in Little London opening times include Bank Holidays as well as Friday, Saturday and Sunday 8am 'til dark. Cash or QR Code. Contact: [odile@the-mansion-house.com](mailto:odile@the-mansion-house.com)

**The HORNCastle NEWS** of 5<sup>th</sup> November reports that Brian Todd Homes Ltd topped the small builder category (East and East Midlands region) in the Pride in the Job Awards run by the National House Building Council (NHBC) for their work at Blacksmiths Lane (Bluebell Woods).

**PARISH COUNCIL** The Parish Council is STILL urgently seeking two more volunteer Councillors to fill the vacancies caused by resignations. There is a poster in the Parish Council section of this magazine. As we have said several times before, far be it from this magazine to propose criteria for selection, but a couple of female councillors would address the current imbalance!

**CHRISTMAS CRISIS SUPPORT** Do you know of anyone in our two villages who will be on their own this Christmas? Agoraphobic? Bedbound? Or perhaps an elderly couple who have only each other with whom to pull a festive cracker? Or a family in extreme poverty? It's everyone's duty to identify and act upon such circumstances, but how? The Church? The Parish Council? The Village Hall? Horncastle Crisis Support? Designated Warm Spaces (do they still exist?), The White Hart? The South Wolds Care Home? Who do you turn to?

**The Edward Richardson Educational Foundation.....**provides grants to young people who live within the villages of Tetford and Salmonby to help with educational expenses and exists to give small grants to those students going on to Higher or Further Education, typically £200-£300. This is advertised on the Parish Council website and on Facebook. This can include text books, course fees, help with computer expenses, tools and clothing for apprenticeships and educational trips. The trustees meet about 3 times per year.

Applicants must be under 26 years of age. Application forms are available from the clerk to the trust at [ppurves@aol.com](mailto:ppurves@aol.com) or Marlene Renshaw 07795 662007.

## TETFORD ST MARY'S BELLS UPDATE *from David Bennett:*

"So, finally, the additional Bells are here! Earlier than we expected but they have been installed and have rung out across the Village to the pleasure of everyone who has heard them. (*The picture is of the first bell being pulleyed through the lower bell tower hatch into the clock room just below the belfry*)

I've been researching the history of all six Bells and have some remarkable findings.

As you know, we had three Bells to start with. Well, the oldest of these dates from 1450! Just imagine that - and it's still ringing out as it has done over the centuries! Another of the original Bells dates from 1617 - again a remarkable old Bell, and the third one dates from 1794 - a comparatively young Bell.



Then we come to the recently installed three Bells. They are much younger, dating from 1869, 1885, and 1893.

Apparently, they had become redundant from where they were and were offered to us. Two of the Bells, the ones dating from 1869 and 1885, had been installed at Stratford St. Andrew, Suffolk and the third one dating from 1893 came from Burnham-on-Crouch Cemetery Chapel.

Quite a history. But now they belong to us in Tetford and have been safely installed, hopefully to ring out for centuries to come!"

*Footnote: If you have been into St Mary's since 2003, you will have seen the display chronicling the renewal and refurbishment of the three original bells. It is hoped to produce a further such display for the installation of the three new bells, to incorporate the current display and to expand upon the history, recent and ancient, of all six bells, and to use updated display techniques.*

**REMEMBRANCE.** On Sunday 9<sup>th</sup> November there was a Remembrance Service at the Tetford Memorial which was very well attended and £255 was raised for the Royal British Legion..



# **Urban Frontierz – The Finishing Touch for Your Home**

**At Urban Frontierz, we believe every home deserves that perfect finishing touch.**

**We offer a wide range of professional services to help you refresh, renew, and personalise your space.**

 **Our Services Include:**

- .Residential Cleaning**
- .Deep Cleaning**
- .Painting & Touch-Ups**
- .Tiling**
- .Custom Artwork for Your Home**

**Whether it's a spotless clean, a fresh coat of paint, or a hand-painted piece of art — we help make your home feel complete.**

 **Call us: 07496 271543**

 **Email: [office@urbanfrontierz.com](mailto:office@urbanfrontierz.com)**

 **Visit: [urbanfrontierz.com](http://urbanfrontierz.com)**

**Urban Frontierz – Because every home deserves the perfect finish.**







# CHRISTMAS CAROLS

at



HARRINGTON HALL, THURSDAY 18<sup>TH</sup> DECEMBER

6.30 pm

## Piano Tuition available

Beginners and early years, any ages accepted.

£10 per half hour.

Please contact Sue on 01507 534800 (Tetford)

## AVON CALLING!

New Avon representative for Tetford and Salmonby area.

If you do not already have an Avon rep and would like to see a brochure please give me a ring.

Shirley 07505 907169

**Black Friday deals and lots of Christmas gift ideas!**



# **PRIZE BINGO**



**@ Belchford Village Hall  
On Sunday 30th November**

**Doors open - 1.15pm  
Eyes down - 2pm**

**Funds going to  
Belchford Church**



**Refreshments  
will be free**



**Look forward to seeing you all  
for a fun filled afternoon**

# **LIGHT A LIGHT**

**FRIDAY**

**DECEMBER 5TH**

**6 PM**

**ST. MARY'S CHURCH**

**Followed by a**

**CONCERT BY**

**HARMONY Lincs**

**7 PM**

**LIGHT REFRESHMENTS**

**Tickets £5**

**Available from Julia 07852877425**

**or Marlene 0779566007**

**On the door £6**

# LETTER FROM JIM SUTCLIFFE REGARDING THE SALMONBY BENDS

*To the Editor*

*Please find below a short piece I've written for the November issue of The Times of Tetford about the ongoing problems with the road at Salmonby Bends. I've also supplied a copy of the Freedom of Information request and the resulting site history report from Lincolnshire County Council, for reference and for anyone who may wish to view them.*

*Thank you, as always, for all the great work you do with the ToT. It's always an interesting and enjoyable read, and a real credit to the village.*

*Kind regards,  
Jim Sutcliffe  
Tetford*

## **Salmonby Bends: Years of Complaints, Zero Progress**

Like many in Tetford and the surrounding villages, I am completely fed up with the state of Salmonby Bends, the main road linking us to Horncastle. It is dangerous, crumbling, and often waterlogged. Over the past few years I have written to several local councillors, our MP, and Lincolnshire Highways, but every response has been the same: it is not a priority. So, rather than keep taking their word for it, I submitted a Freedom of Information request to Lincolnshire County Council to see for myself what has been going on. The reply was eye-opening.

The report I received covers the last five years and shows:

- Dozens of logged defects and complaints from residents
- Repeated pothole and verge repairs that fail within weeks
- Notes from highways officers stating that the road needs a full resurfacing and drainage scheme (first raised in April 2024 and again in February 2025)
- Ongoing problems with natural springs beneath the road causing the surface to break up and wash away

In short, the council has known about these issues for years and still nothing meaningful has been done. What is even more frustrating is that both our former County Councillor, Hugo Marfleet, and District Councillor, Daniel Simpson, have previously acknowledged the problem and its cause. They both confirmed that the road's deterioration is due to underground springs and poor drainage, and that a full resurfacing and drainage scheme would be required. Despite these admissions, no such work has taken place.

I have forwarded the full information to our new County Councillor and will also be contacting the Mayor for Greater Lincolnshire. That said, after several years of correspondence with various officials, I am not holding my breath for meaningful change. I have supplied *The Times of Tetford* with a copy of the Freedom of Information request and the full site history report should anyone wish to view them. (*contact the magazine and we'll email them to you – Ed*)

Anyone who drives this route knows how unsafe it has become, particularly during winter when standing water hides deep potholes on the blind bends. It is time this road received the proper resurfacing and drainage work that has already been identified by highways officers, rather than more temporary patching.



# Quiz answers. Horncastle Market Square Shops

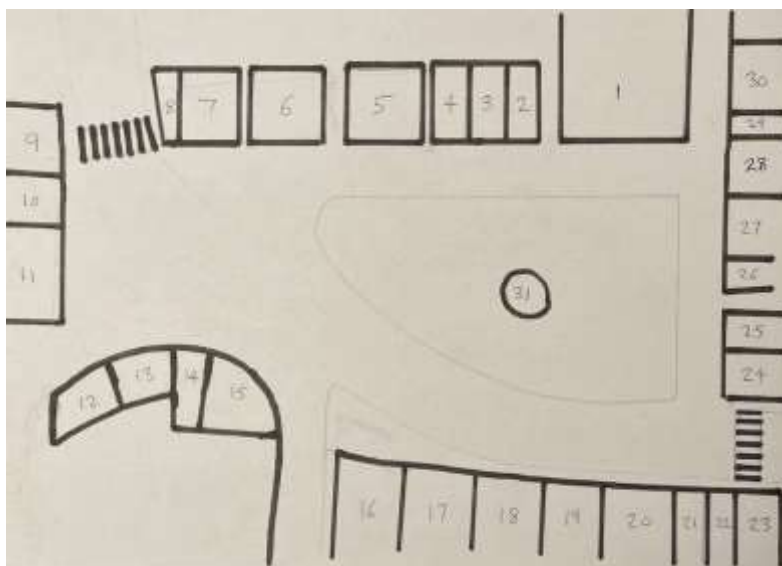

- |    |                                  |                                                                             |
|----|----------------------------------|-----------------------------------------------------------------------------|
| 1  | Post Office                      |                                                                             |
| 2  | Doodles Diner                    | Café                                                                        |
| 3  | The Foot Doctor                  | Foot health                                                                 |
| 4  | Bull Ring Barbers                | Barbershop                                                                  |
| 5  | Locks and Leather                | Shoe repairs, key cutting, trophies, leather...                             |
| 6  | Lindsey Age UK                   | Retro & Vintage second hand                                                 |
| 7  | Perkins                          | Newsagent                                                                   |
| 8  | Overtons Corner                  | A window display of Horncastle history<br>(formerly Archers fish and chips) |
| 9  | Horncastle Eye Care              | Opticians                                                                   |
| 10 | Lincolnshire Co-op               | Funeral Services                                                            |
| 11 | Heron Foods                      | Food supermarket                                                            |
| 12 | Natura                           | Pizzeria (formerly Little Caesar's)                                         |
| 13 | Cyber Candy                      | Tattoos and piercings                                                       |
| 14 | Shoes by Grace                   | Shoe shop                                                                   |
| 15 | Grace's Boutique                 | Women's fashion                                                             |
| 16 | Empty                            | formerly Barclays Bank                                                      |
| 17 | Cooplunds                        | Bakery                                                                      |
| 18 | Lincolnshire Co-op               | Pharmacy                                                                    |
| 19 | Luce Ends                        | Barbers (new site formerly The Busy Butcher)                                |
| 20 | Pedal and Pause                  | Café (formerly a bike shop too: Just One More)                              |
| 21 | Empty                            | formerly Luce Ends                                                          |
| 22 | Empty                            | formerly H A Stanley                                                        |
| 23 | The Gents                        | Barber Shop                                                                 |
| 24 | Blossom                          | Hair and Beauty Salon                                                       |
| 25 | Empty                            | (formerly Grace's Boutique)                                                 |
| 26 | Sunny's                          | Fish & Chips, restaurant                                                    |
| 27 | Horncastle Pizza and Kebab House |                                                                             |
| 28 | Costa                            | Coffee shop                                                                 |
| 29 | Wok this Way                     | Chinese take away                                                           |
| 30 | Tanya's                          | Café                                                                        |
| 31 | Edward Stanhope memorial         |                                                                             |

## The Men on the Tetford War Memorial *by Jonty Wild*

**Pte. 9949, George Charles Brooker, 8th Bn., Royal Lancaster Regiment.  
Died 26/04/1917.**



George was born in Wood Green, Middlesex in 1885. The fifth child and first and only son of George and Eliza Jane Brooker (née Gardiner). They were born in Beckenham, Kent and Colney Hatch, Herts., respectively. He had four siblings, all older and all sisters and, like George, all were born in Wood Green.

By 1891 they had moved to Streatham, London, George's father was absent, and his mother was listed as 'Head' but still married, however by 1901 Eliza was a widow and back living in Wood Green - we believe George died in 1895. She and her eldest

daughter worked as laundresses and George as a greengrocer's boy.

By 1911, George was 25 years old and in the 1st Battalion of the King's Own (Lancaster) Regiment. He had 3 sisters living in Finsbury Park, 2 together and another (married) living with her husband and their mother. Their houses were just a few hundred yards apart. George's future wife, Grace Emily Lancaster, was working as a cook less than a mile away - perhaps it is through them that he met Grace – and she is his connection to Tetford.

Establishing George's war experience is difficult because there is no service record, and he was transferred between the 2<sup>nd</sup> and 8<sup>th</sup> Battalions, Royal Lancaster Regiment at an unknown date. I suspect this was due to a wounding, but I have found no proof. As a result I have to surmise, until the point that we can be certain he was in the latter<sup>\*1</sup>. We know that he did not go to France until January 15<sup>th</sup>, 1915, so he was probably called up from the Reserve. The 2<sup>nd</sup> went to Salonica in October 1915, and he was not with them, but we can be certain that George was in England, with Grace, in August 1914 (first child conceived), late December 1915 (when they married) and April 1916 (second child conceived). Grace probably moved to Tetford to be with her parents when she knew that she was pregnant, and that George was going into the Army.

He was with the 2<sup>nd</sup> Bn. in February 1915. They were in the front line trenches south of the canal near Oosthoek, Belgium and between the 3<sup>rd</sup> and 7<sup>th</sup> war became very real when 7 Other Ranks (ORs) were killed and 46 wounded. The weather was cold and wet, and the War Diary recorded that 1 officer and about 140 men were sent to hospital suffering 'Trench Foot'. George was not with them so he probably experienced the German attack on the 17th at Zwartelen (Belgium) and the British counterattack by bayonet charge, to recover the lost trench - 4 officers were killed and 1 wounded, plus 18 ORs killed and 33 wounded. He also probably experienced the attack on the 20th when they supported an attack to recover a trench previously lost. An NCO made it back and reported that "*all the officers of the Company and a half had been shot down, that a few of the rank and file had reached & entered the trench which was the object of their attack and found it empty except for dead Germans*" - 6 ORs were killed, 7 were missing, 42 wounded, together with 2 officers and another wounded and missing. On the 21st the War Diary records about another 80 men went to hospital on account of 'feet'. Again George was not one of them, but by February 24<sup>th</sup> he had joined them and was admitted to No 3 Casualty Clearing Station and then evacuated by ambulance train with many others. We do not know how long it took him to recover, but it is unlikely to have been so long that he did not go back to the 2<sup>nd</sup> Bn.

The 2nd went on to incur significant casualties, e.g. April to May 3<sup>rd</sup>, 1915, 7 officers and 142 ORs wounded, plus 25 ORs killed. Then between May 4<sup>th</sup> and 8<sup>th</sup> (2nd Battle of Ypres), 4 officers were killed, 1 was believed killed, 5 were wounded, 2 wounded and taken prisoner, 1 was taken prisoner, 2 were simply missing and another was hurt in a fall, plus, in the ORs 36 killed, 110 wounded, 31 wounded and missing, and as simply 'missing' a truly staggering 712. Unusually there is a list of names, but George is not one of them. He could still have been wounded and given that a battalion was about 1000 men, and he was not one of the missing, it would perhaps be a miracle if he was not. This, the fact that he did not go to Salonica in October, and for other reasons, is why I think that he was wounded and probably transferred to the 8<sup>th</sup> Battalion, when he recovered. However as we have no date, I can only surmise this and pick up his story when we can be sure he was with the 8<sup>th</sup> Bn. They suffered significant losses in 1916, and George may have fought with them, but we can only be sure that he was with them in Arras, April 1917, when he and many others were involved in the preparation for the Battle of Arras, which is when he died.

At the beginning of April they were near Arras digging assembly trenches. The Germans knew of the preparations and at midnight on the 6<sup>th</sup> they started shelling with gas and explosive shells. Then the British massive bombardment commenced, some 3000 guns fired 2.5 million shells – this was massive: in the 7 days before the Battle of the Somme only a million shells had been fired. On the 8<sup>th</sup>, final preparations were made and at 10pm they moved to the assembly trenches. The attack was launched at 5:30am on the 9<sup>th</sup>, with George's Battalion in reserve - although some men carried ammunition for the lead attackers. It went well; the first 3 lines were taken as planned. The Royal Lancasters, 'A' Coy., moved forward, with the remainder waiting until noon when they were ordered forward to consolidate captured trenches and make a roadway for the cavalry. At 6:35pm they were ordered to attack what was known as the Brown line at 7pm. That was impossible as that line was over 1¼ miles in front, nevertheless they did move forward and arrived in time to fill the gaps left by the Gordon Highlanders, who had dug in too far to the right. Then just before dawn they withdrew to a position that allowed others to take over for the next attack. The next day (11<sup>th</sup>) at 4:30am they prepared to attack and recapture Guemappe. They were seen and heavily shelled, but only briefly. The main attack commenced and went well until they passed the crest of a hill, then machine gun and rifle fire caused heavy losses. They were forced into shell holes for cover, many of these were already occupied by the remnants of the previous days' attack, including the dead. When the Gordons attacked at 4:30pm the men in the shell holes joined them as they passed, but the attack was another failure. Casualties for the period April 8<sup>th</sup> and 12<sup>th</sup> were 5 officers killed and 11 wounded, 38 ORs killed, 164 wounded and 28 were missing.

George was recorded as killed in action on April 26<sup>th</sup>, but we have no details. His Battalion had been out of the line but returned to the trenches on the night of the 23<sup>rd</sup>/24<sup>th</sup>, only 2 casualties were recorded on the 25<sup>th</sup> and none on the 26<sup>th</sup>, but they experienced heavy rifle and machine gun fire and intermittent shelling on the front and support trenches. George could have been killed at this time or earlier and the date miss-recorded. His body was never found and that is why he appears on the Arras Memorial, amongst the other 34,716 names of the missing.

Grace lost George her husband and her two brothers, Ernest and William Lancaster. She stayed in Tetford after the war with their two young children, receiving a pension of £22 11s a week.

*\*I As with all the Tetford men, but especially George, far more detail is given in the 'full' version available via [jontywild@byacatswhisker.co.uk](mailto:jontywild@byacatswhisker.co.uk) or are available to read in the Tetford Church.*

*If you can add anything for the men, such as information/photographs/corrections please tell me. Jonty Wild*

## GROUP NEWS

### **TETFORD & DISTRICT W.I.**

*from Stephanie Wilkinson*

#### A Storytelling Evening

A good time was had by all at our meeting on October 22nd.

'Are you sitting comfortably?' is the traditional beginning of a storytelling session. So our members and guests were sitting as comfortably as the Village Hall chairs allowed, having just enjoyed a delicious buffet supper, up to the usual high Tetford standard. Many if not most of us had already spent some of our Christmas present budgets, being attracted to the lovely items displayed on the WI 'Gifts to Go' stall.



We were looking forward to hearing a selection of Lincolnshire tales, along with ghost stories and fairy tales from around the world. Our storyteller, Keith Butters, who has lived in our area for all his life in a dwelling dating back generations of his family, certainly looked the part. He was dressed in a splendidly traditional manner in a tailcoat suit with a yellow belly (his term) waistcoat.

Our Committee had gone out of their way to furnish his 'set' in a similarly traditional way with an armchair, side

table and lamp.

We heard about Keith's life and times, he revealed that he originated from a line of bootmakers (which need to be distinguished from cobblers he said). Interwoven with these accounts, he entertained us with a selection of fascinating folklore and historical tales. It was particularly interesting that the memory of an audience member was stirred by Keith's stories of his forbears. She recounted her own told tale of her grandfather's boyhood encounter with a daunting past Mr Butters, when the grandfather was sent to ask him politely for some boots to be repaired.

A few listeners with active imaginations, myself included, may have gone home that evening wondering if dragons had really lived in The Wolds in past times.

Our next meeting is on Wednesday 26th November when we will be making our own Christmas wreath, led by creative local crafter Lucy Noad.

Further details can be obtained from our President, Terri Willings on 01790 612341.

### **READING GROUP**

*from Karen Watkins*

The Reading Group's next meeting is on Friday 28th November. The book to be discussed will be *The Enchanted April* by Elizabeth Von Armin. Contact Karen at [kwatkinshmg@gmail.com](mailto:kwatkinshmg@gmail.com)



Sadly, one walk had to be postponed due to me waiting in for EE / Openreach to sort out my internet connection – unusable since the end of August. The good news (for me anyway) is that we now have a fibre connection – it just took 4 routers, 5 power adapters, 3 wall sockets, 8 visits by 10 engineers, 2 cancelled fibre installations, maybe 25 phone calls and 1 successful installation visit to fix it!

Hopefully by the time this is published we will have completed the postponed Tealby walk, and then the next walk will be on Wednesday 17<sup>th</sup> December, and is probably Simon Wood's Christmas Walk – Horncastle to Thimbleby, as previously published in this magazine – thanks Simon.

The first one in the New Year is on 7<sup>th</sup> January and will probably be about 5m around Aswardby to Brinkhill, but if you want to be certain get in touch – new walkers very welcome.

Beautiful countryside, friendly walkers and lifts are always available, when the start is elsewhere. We meet at the village hall at 9:50am to leave 10am prompt (Church bell), but if you plan to join us, and you are not already a member, it would be really helpful if you would contact [jontywild@byacatswhisker.co.uk](mailto:jontywild@byacatswhisker.co.uk) or 534075 in advance, as this will save time on the day.

**FOR SALE**

Electric Coal-Effect Fire. Fits into grate.

£10

Tel. 01507 533769 (Tetford)

**Dean Wilkinson Decorating Services**

All types of painting and wallpapering

Based in Tetford

Friendly advice and free estimates available

Call 07584 679744 or email [deanwilk28@gmail.com](mailto:deanwilk28@gmail.com)

## CHURCH NEWS – St. Mary's, Tetford

A Sunday informal worship is held on the first Sunday of the month in St Mary's Tetford at 10am. The next is on December 7<sup>th</sup>. There is time for coffee and a chat afterwards, all welcome.

December is a busy month, starting with the lighting up of our Christmas Tree, a short 'event' at 6pm on Friday 5<sup>th</sup> December outside the church (all welcome), followed by a short service to bless our new bells. Following the service there will be a Christmas Concert in the church by 'Harmony Lincs', tickets £5 pre-booked or £6 on the door. For tickets, contact Julia Larder on 07852 877425 or Marlene Renshaw on 07795 662007 (see poster at front of this magazine).

The Edward Richardson School's end of term concert will take place in the church on Wednesday 19<sup>th</sup> December (school only).

### Friends of St Mary's

The friends help with the upkeep of the Church and Churchyard, many thanks to everyone who cleans, provides the flowers and particularly with keeping the Churchyard tidy, you really are appreciated. Donations towards the upkeep of St Mary's Church can be made to 'Friends of St Mary's' account number 34267660; sort code 30-99-50. Cash, and cheques payable to "Friends of St Mary's" please deliver to 'Hill View', North Road, Tetford.

## THE SOUTH ORMSBY GROUP OF CHURCHES

For general enquiries contact the Rural Dean Reverend Fran Jeffries 01790 752526

BAG ENDERBY BRINKHILL CALCEBY DRIBY FARFORTH KETSBY HARRINGTON HAUGH

Each month there is a lay-led family service at **Tetford St Mary** on the first Sunday of the month and then two weeks later a further service in one of the other churches in the South Ormsby Group, taken by a member of the clergy.

|                      |     |                           |                         |        |
|----------------------|-----|---------------------------|-------------------------|--------|
| Sun 7 <sup>th</sup>  | Dec | Tetford St Mary           | Informal Service        | 10am   |
| Thu 18 <sup>th</sup> | Dec | Carols at Harrington Hall |                         | 6.30pm |
| Wed 24 <sup>th</sup> | Dec | Tetford St Mary           | 9 Lessons & 9 Carols    | 6pm    |
| Thu 25 <sup>th</sup> | Dec | Tetford St Mary           | Christmas Day Communion | 10am   |
| Sun 4 <sup>th</sup>  | Jan | Tetford St Mary           | Informal Service        | 10am   |
| Sun 18 <sup>th</sup> | Jan | Somersby St Margaret      | Eucharist               | 6pm    |
| Sun 1 <sup>st</sup>  | Feb | Tetford St Mary           | Informal Service        | 10am   |
| Sun 15 <sup>th</sup> | Feb | Brinkhill St Philip       | Evening Prayer          | 6pm    |

BAG ENDERBY BRINKHILL CALCEBY DRIBY FARFORTH KETSBY HARRINGTON HAUGH

MAIDENWELL OXCOMBE RUCKLAND  
SALMONBY SOMERSBY SOUTH ORMSBY  
TETFORD WORLABY

MAIDENWELL OXCOMBE RUCKLAND  
SALMONBY SOMERSBY SOUTH ORMSBY  
TETFORD WORLABY

## THE HAMILTON HALL

is available to hire for all events such as private parties or fundraising events. **To book the hall ring Marlene on 07795 662007**

|                                                                                       |                                                                                                                     |
|---------------------------------------------------------------------------------------|---------------------------------------------------------------------------------------------------------------------|
| <b>Hamilton Hall Committee</b><br><br>Kate Stark (Chair)<br>David Needs<br>Pat Sparks | <br><br>Paul Head (Treasurer)<br>Marlene Renshaw (Bookings etc.)<br>Pat Harrison (Secretary)<br>Lesley Harper-Smith |
|---------------------------------------------------------------------------------------|---------------------------------------------------------------------------------------------------------------------|

- A Christmas Party will be held in the hall for families on Saturday December 13<sup>th</sup>. Please book. Details are on the poster at the front of this magazine. All welcome, free entry.
- The Village Hall committee wish everyone a very merry Christmas and a Happy New Year.

### **REGULAR HAMILTON HALL ACTIVITIES and FACILITIES:**

**Short Mat Bowls**, Tuesdays at 7.30pm Contact Mr D Needs 01507 533705. The Bowls Club re-convened on the first Tuesday of September. New members always welcome and the first three evenings are free. A friendly bunch, will be pleased to see you.

**Table Tennis** Monday evenings from 7-9pm and Thursday afternoons from 2-4pm. Email [tetfordtabletennisclub@gmail.com](mailto:tetfordtabletennisclub@gmail.com) for enquiries. The club has five tables.

**Pilates-Plus** Mondays 09.30am. Contact Debbie Jenner [debbiejenner@outlook.com](mailto:debbiejenner@outlook.com). £9 per class.

**Teas for the Walkers** This service is available for booking in the Hamilton Hall by walkers' groups. Groups should contact Marlene Renshaw 01507 533209

**Parish Council** Usually 2<sup>nd</sup> Wednesday of each month 7.30pm. Residents welcome to attend. *See feature(s)*

**Tetford and District W.I.** Fourth Wednesday of the month 7.30pm (*see Group News*). Contact Terri Willings (Branch President) 01790 612341

**Tea and Chat** Tuesday afternoons 2 – 4pm except the first gathering of the month which will be on the Wednesday morning of the first week starting at 10am. All welcome.

Pilates-Plus classes in Tetford Monday 09.30 Hamilton Hall  
£9,- per class

Build a stronger core, improve your posture- flexibility, mobility, breathing and circulation. Learn to move your spine in a safe, effective way and all that in a mindful, gentle manner. The 'Plus' comes from extra stretching and mobilising exercises with use of balls in various sizes (can be supplied). You just need your mat.

Classes are for all levels and ages taught by Debbie Jenner a teacher trainer with more than 24 years experience of teaching Pilates to instructors and consumers and 43 years of group exercise teaching.

Contact for more info/questions: [debbiejenner@outlook.com](mailto:debbiejenner@outlook.com)

## Alone

Alone, alone, alone again  
Mellow Music fills the air  
Glass of wine in hand  
Helps pacify deep despair

Contemplating, not knowing  
What the future has in store  
The present moment is empty  
Life promised so much more

However many suffer  
These pains of aching heart  
Fulfilled when together  
Too often though apart

Love permeates all boundaries  
Deep passion cannot be tamed  
Exploding to life when love is made  
An eternal ethereal flame

Many years of patience tested  
Silent searching of the soul  
To be fulfilled in heaven, maybe  
Justified be the greatest goal

*Man Yarner*

The first method for estimating the Intelligence of a ruler  
is to look at the men(and women) he has around him.

Niccolo Machiavelli



## **Kia and the Faceless Monk** by Lara Watson, aged 9

This is an ordinary story in an ordinary town. It's where no-one was scared that much, until someone was.....!

### **Chapter 7**

*At the end of Chapter 6 the witch was just about to tell Kia and her friends about the Great Huffingdon monsters which were half ice and who the monk next door had said were useless and he had "discarded" them...*

After hearing the witch's story, they decided to go back to their house, but they found the door... open. Maisie screamed. The others hadn't noticed. A scream came from her side: Rozzi looked up. He screamed. A ghost. No, not a ghost. A faceless monk.

It spoke. It sang. "Something of yours will be hidden. Gone on a full lunar light. Maybe a gem, maybe a friend, never to be seen again," he went on repeating. Kia wrote it all down. The monk floated away into the forest. "What did that mean?" Rozzi questioned.

"Lunar means moon" said Maisie. "It must be a full moon by what it says!" "Yes, but what could be taken?" said Kia. "Yes, what?" "No idea" They all sighed. They were exhausted. "Well, I say we go to sleep and meet tomorrow, agree?" "Sure!" they agreed. Then they all went to bed. No one fell asleep.

\*\*\*

The next day they sleepily met up in the town square to head into the forest. Soon the houses started to thin out again. They came to the monk's house and started clomping up the path. But the path started to flow in on them. Suddenly everything went black...

### **Chapter 8**

When they woke up they seemed to have ice crystals round their eyes. "What is this stuff?" Rozzi asked wiping his eyes.

"Where are we? I think is more important" said Kia.

"It looks like some sort of cellar," Maisie groaned, "let's go look around. There's a shape over there, let's explore!"

They got up and ran over to it. "I...it's a deer!" Rozzi stuttered, "What's wrong with it?" "It looks lifeless!"

Kia gazed in awe. Suddenly, the faceless monk came out of the deer and said "That was called a soul suck. I'll suck the life out of you. Tonight! You don't know why, do you? Ha! Ha! You haven't realised yet! Tonight's a full moon!"

With that he started sucking. First Maisie, then Rozzi. Kia knew she was next...

*To be continued!*

## LUCK OF THE DEVIL...*Anonymous*

Discontent among the lottery-playing public was at an all-time high. Nick Naylor sat in front of the TV, clutching a lottery ticket, sweatily. Following last week's 'fiasco' he'd chosen five lines of 'lucky dips' £2 apiece, for the not inconsiderable sum of £10.

"It had to be a scam!" said Jude, his other half, toying with her dyed auburn locks.

The previous week, the nigh-on-impossible had happened. Numbers one to six had been picked - in sequence.

A presenter's smarmy face, replete with a stitched-on smile, filled the screen. "Well, after last week's *spectacular* draw, the first time *ever* six consecutive numbers have been drawn in a major lottery, let's see what the balls have for us *this* week!"

The shot switched to balls spinning in a transparent machine.

"Just to reassure everyone watching, all sets of balls and all machines have been thoroughly checked by engineers and nothing untoward was found!"

The balls started to emerge from the machine, feeding into a long tube.

"And the first lucky number is, Oh my God, seven!"

The presenter seemed shell-shocked. So much so that the number eight rolled down the tube without being announced. Then nine, then ten, eleven and finally, and predictably, twelve.

There was a stunned silence in the studio, and in fact in every lottery-watching household in the country. And before long in every media-capable household in the world. Suddenly, the programme vanished from the screen. "And in place of the published programme, another chance to see Episode 17 of 'Arctic Diary' with David Attenborough."

"Oh no, not that wildlife stuff *again*!" said Jude.

A week of feverish activity had seen all balls and machines replaced and the studio lined with lead. After every possible conspiracy theory had been exhausted - hackers, aliens, communists - you name it - and all employees given a lie detector test, Jude and Nick sat down to watch the draw again. There was no spiel this time, just a simple "Let the draw commence!" before a little-known 'celebrity,' notable only for her sizeable bosom, bounced onto the stage to push a red button. "Good luck everyone!" she giggled, jiggling her assets.

"And the first number is ... *thirteen*. Oh ..." The presenter keeled over in a dead faint, just as the next ball rolled out. A collective sigh of relief rang around the world at 58, then 24, 37, 16 and 40.

A substitute presenter raced onto the set to announce these numbers, looking as if he'd won the jackpot himself.

"What d'you think it was all about?" said Jude.

"Who knows? Perhaps something or someone was trying to demonstrate their power."

"What, like God?"

"I dunno, maybe the other one."

"Then the power of good won over evil!" said Jude.

Nick pondered. "Either that or it was just a freak of chance."

He looked at his ticket. "Hey, guess what, I just won thirty quid!"

"That's good!"

"Yeah, I can buy *The Complete Arctic Diary* on DVD!"

## FILM RUNDOWN by James Learoyd

Hi all! I hope everyone is well. Quite the random selection for you this month.

***I Swear*** feels like a progressive step when it comes to educating people about Tourette syndrome and those living with it. This is an authentic, important work which certainly educated me on the subject. It's emotionally engaging and considerably distressing. It really places you in the perspective of John Davidson. But I'm not sure that it uses filmmaking, and all its potential, beyond that. Nevertheless, its social significance cannot be overstated. Featuring great performances from Robert Aramayo and Maxine Peake. (At the Kinema till November 20.)

***A House of Dynamite*** is the new nuclear thriller from Kathryn Bigelow and depicts an 'end of the world' scenario from multiple governmental perspectives. Whilst the stakes are established effectively, unfortunately this becomes a movie which muddles itself beyond repair, narratively speaking. What you do get is tension, procedural insight, and a couple of good performances (specifically Rebecca Ferguson). (Now on Netflix.)

I found Guillermo del Toro's new vision of ***Frankenstein*** to be quite the disappointment. Especially since the production values on display in this movie are awe-inspiring. The production design alone gives one plenty to celebrate – and many critics are loving this movie. But to me, clocking in at 2hrs 30mins, it remains inert and tonally off. I'll always admire del Toro, but at this point in his career, I expect something more carefully measured. (Now on Netflix.)

***Predator: Badlands*** is a film I've watched three times now in my capacity as usher at the BFI IMAX in London. It's a pretty good sci-fi, action spinoff – and a unique entry in that the titular Predator is our empathetic protagonist. If there's one standout, it would be the impeccable visual effects and creature design. There are so many cool little details to spot in the world of this film. (Now showing at the Louth Playhouse Cinema.)

***Roofman*** is my big recommendation. It's a new romantic drama based on a true story, starring Channing Tatum and Kirsten Dunst, about a man on the run after robbing McDonald's. He hides out in a Toys R Us and falls in love with Dunst. Both leads are award-worthy in their roles, and I've always argued that Tatum can do no wrong as a dramatic actor. It's still showing at select cinemas, so catch this incredible film while you can – and then watch it on streaming!

Since my last piece, Diane Keaton sadly passed. In her memory, I decided to watch a couple I'd never seen before, and I found a love for her performance in *Father of the Bride* which you can now watch on Disney+. Additionally, we're getting ever closer to Christmas! In a previous issue I highlighted *Carry-On* which you can watch on Netflix – it's the new *Die Hard*! I'll also just note that the action masterpiece *Collateral* will be leaving Netflix very soon. If you haven't watched it, please do. It's a crowd-pleaser.



Louth Choral Society *presents*

# MARY, SACRED ROSE

*Music for Advent*



World-premiere  
performance of  
**The Canticle of  
Mary**  
by Alison Willis

**Ceremony of  
Carols**  
by Benjamin Britten

Alison Willis  
*Conductor*

Olivia Thomas  
*Soprano*

Eira Lynn Jones  
*Harpist*

Graham Eccles  
*Organist*

**Sunday 30th November 2025 at 7pm**  
**St James's Church, Louth**

Tickets: reserved £18, accompanied u18 £10; unreserved £12, u18 free

Available from Beaumont's, 11 Bridge Street, Louth  
and online at [www.ticketsource.co.uk/louthchoral](http://www.ticketsource.co.uk/louthchoral)

Reg. Charity 1006998





**NODA**  
for every stage

**HORNCASTLE THEATRE COMPANY PRESENTS**

**HORNCASTLE**  
THEATRE  
Company

# **GASLIGHT**

**BY**  
**PATRICK HAMILTON**

**DIRECTED BY**  
**ADELE SIMPSON**

**WEDNESDAY 19th - SATURDAY 22nd NOVEMBER 2025 at 7.30pm**

**Tickets: £10.00 or £9.00 concessions can be purchased from our Box Office,  
Kennedy's in the Bull Ring (cash only, entrance from Horse Fair Walk)  
or on the door subject to availability.**

**Or Online at: [www.horncastletheatre.co.uk](http://www.horncastletheatre.co.uk)**

**This amateur production of 'Gaslight' is presented by kind permission of Concord Theatricals Ltd  
[www.concordtheatricals.co.uk](http://www.concordtheatricals.co.uk)**



HORNCastle  
CHORAL  
SOCIETY PRESENTS

# *Handel's* MESSIAH

PART ONE

Plus the HALLELUJAH CHORUS

with seasonal carols and audience participation

FRIDAY 12<sup>TH</sup> DECEMBER 2025  
7.30 PM



CONDUCTOR  
ROBERT STEADMAN

ACCOMPANIST  
CHRIS HINKINS

St Mary's Church - Horncastle  
**Admission:** £10 pre-paid - or on the door

Refreshments included



SCAN ME



## **CHILDREN and SCHOOL SECTION**

### **ANSWERS TO THE OCTOBER QUIZ**

(1) 52 (2) 4 (3) primary colours (4) The Witches (5) United Kingdom (6) Tea (7) Taylor Swift (8) a group of notes played together (9) Percussion (10) Queen (11) Stormzy (12) False (13) Butterfly (14) Scotland (15) True (16) False, known as the 'Magpies' (17) Alan Shearer (18) An Ace (19) Golf (20) Rugby

### **ANSWERS TO THE OCTOBER RIDDLES**

- Incorrectly!
- A green bucket!
- Dung!

### **THE NOVEMBER QUIZ**

1. What is table tennis also known as? Mini tennis/Ping pong/ Paddle ball?
2. How many earths could fit inside the sun? Around 30,000/around 300,000/around 1.3 million?
3. Sputnik 2, the second satellite to be launched into orbit, had a dog on board – true or false?
4. The sun revolves around the earth – true or false?
5. The first human being in space was from which country – The USA? Russia? China?
6. The brightest star in the night sky is called Sirius. What other name is it known by? The Cat Star/The Dog Star/The Mouse Star?
7. Lara Croft is the main character in which famous video game series? Just Cause/ Tomb Raider /Uncharted
8. Which of these is the biggest? Megabyte/Kilobyte/Gigabyte?
9. Who was Florence Nightingale? An opera singer/a dancer/ a nurse
10. If you are protected from a disease, are you inhumane? Immoral? Immune?
11. Which type of plant is best known for growing in paddy fields? Oats/Wheat/Rice?
12. Why do flowers have pollen? To feed bees/to reproduce/to give people hay fever?
13. What is H<sub>2</sub>O more commonly known as? Water? Soil? Sand?
14. Which wild-haired scientist gave us the equation  $E=mc^2$ ?
15. If you hold the north poles of two magnets together, what happens? They stick together/they push apart/they float
16. Which scientist came up with the force of gravity when he observed an apple falling from a tree? Isaac Newton/Albert Einstein/ Charles Darwin
17. When you boil water, the liquid turns into what? A gas/a solid/ a plasma
18. What are the two holes in your nose called? Sockets/Nostrils/Breath holes?
19. How many chambers does the human heart have? 6? 4? 8?
20. Which type of teeth do we use to effectively chew our food? Molars? Canines? Incisors?

### **RIDDLES**

- Why is getting up at five in the morning like a pig's tail?
- Why was six unhappy?
- An electrician and a plumber were shopping in a hardware store. One of them is the father of the other's son. How can this be?

# The Edward Richardson Primary School

*This month, we're trying something a little different. Having been inspired by the creative writers who regularly contribute to TTOAS, we're handing the page over to one of our own budding authors.*

*Thomas, one of our Year 6 pupils, has kindly allowed us to share the opening to his exceptional narrative. We are incredibly proud of the level our children reach with their writing, and over the year we will be showcasing more examples from across the school.*

*You may recognise the clever twist he has placed on a well known story. We hope it draws you in and leaves you wanting to read on...*

In the outskirts of an emerald oasis stood a quaint cottage in which lived a young girl and her mother. Among the rose bushes skipped a young, care-free girl wearing a ruby-red, velvet cloak whose name was Little Red.

"Red!" called Mother, "Red, come and take this cake and medicine to Grandma."

Red came into the kitchen and found Mum trying to pluck the cookies from the scorching hot tray without burning her fingers.

"The basket's just there," mentioned Mum indicating the basket whilst nursing a burned finger.

With that, Red set off through the forest, wishing she could help with the finger.

"Well, well, well, where are you going my dear?" exclaimed a slick grey wolf, emerging from the depths of the wood.

"I'm taking these to my poorly grandma," replied Red.

"Oh, how nice," grinned the wolf, "I do hope she gets better soon."

And with that, he shrank back into the shadows.

**\*CRACK\***

Red wheeled around to see a branch had snapped behind her, tearing through the other branches, pulling all the trees in, blocking the light and the path. Red drew her cloak tighter around her and set off again, a little quicker this time. As she pursued, bony skeletons lurked down at her as a murder of crows cawed, circling above. Just then, a flash of lightning illuminated the darkening sky along with a clap of thunder. That's when the rain started- great enormous droplets, litre upon litre, pint upon pint splashed down. Red drew her cloak tighter still, flung her hood up and sprinted towards the edge of the woods and Grandma's house.

Eventually, Red pulled down her hood and was just about to enter when she spotted muddy paw prints leading out of the depths of the silent eerie woods and in through the unlocked and slightly ajar, wooden door. Gingerly, Red pushed the door further open...

*Best wishes,  
Stuart Spendlow  
Headteacher*

*The Edward Richardson Primary School  
W: <http://edward-richardson.lincs.sch.uk/>  
T: 01507 533686*

## CLUBS, SOCIETIES, ACTIVITIES and FACILITIES (1 of 4)

**TETFORD RECREATION GROUND** If anyone feels they would like to make a donation (thank you to those who have) or to support us through our weekly lottery (it's £1 per week by direct debit – cancel anytime) then please get in touch, lottery details below. We continue to seek grant funding where we can to keep the rec going for the next year.

Many thanks to you all.

[www.selcplottery.co.uk/support/tetford-and-salmonby-recreation-ground](http://www.selcplottery.co.uk/support/tetford-and-salmonby-recreation-ground)

Secretary Alison Sparks Email [alisparks@sky.com](mailto:alisparks@sky.com) Tel. 01507 534384; Chairman Paul Learoyd Email [paullearoyd@gmail.com](mailto:paullearoyd@gmail.com) Tel. 07885 135406

**THE MANSION HONESTY SHOP** for homemade bakes in Little London is open Fridays, Saturdays, Sundays and Bank Holidays 8am 'til dark weather permitting and while stocks last.

**CRICKET** Tetford Cricket Club's home ground is the village recreation ground. The team plays on Sundays in the East Lindsey Cricket League. Information about fixtures, results, teams and stats can be found by searching for **elcl.play-cricket.com** on the Internet. Mark Hughes is captain (07887 750696) and Kai Stephenson is vice-captain (07871 720882). Mark Kelsey (07789 626804) is the face of the team in Tetford, being the local postman! The team has 2 gazebos for them to change in, plus plenty of seating for spectators.

**TETFORD WALKING GROUP** – Jonty Wild [jontywild@byacatswhisker.co.uk](mailto:jontywild@byacatswhisker.co.uk) 01507 534075

**SOUTH ROAD RED TELEPHONE KIOSK** The kiosk acts as a book exchange and tourist information hub

**FISH and CHIPS** The Jolly Rogers Mobile Fish and Chips van stops in South Road opposite the Care Home between 5pm and 5.15pm every Monday.

**HORNCASTLE LIBRARY** is open Monday 9am-4pm; Tuesday Closed; Wednesday 9am-1pm; Thursday 9am-6pm; Friday 9am-5pm; Saturday 9am-1pm; Sunday Closed. Tel. 01522 782010 (Lincs County Council)

**MOBILE LIBRARY SERVICE.** The Mobile Library stop at Tetford has been withdrawn due to insufficient borrowers using the service. Borrowers who struggle to reach their local library or community library facilities, due to mobility, age or ill health are invited to use the Access Mobile North home delivery service instead. Contact Graham Owen (Team Leader North) tel. 07483 017085 – email: [graham.owen@gll.org](mailto:graham.owen@gll.org) with your library borrower number and he will add you to the route, all free. Delivery/ Collection is monthly, on Thursdays 2025:- November 20<sup>th</sup>; December 18<sup>th</sup>

**THE HORNCASTLE TOURIST INFORMATION CENTRE (Tel. 01507 526065)** is in the Sir Joseph Banks Centre at 11 Bridge Street LN9 5HZ, run by the Sir Joseph Banks Society. Follow the link <https://joseph-banks.org.uk> to start. The centre is also home to the Horncastle History and Heritage Society <https://horncastlejbc.info/horncastle-history-heritage-society>; some battery and printer ink recycling, a natural history museum and Victoria Atkins, our local MP. It is open from 10am-4pm, Thursday, Friday and Saturday (having said that, members of the individual societies and groups are often around outside those hours, so if you are happy to take pot-luck...). The Society is working on creating a digital OS Map of local places of interest.

## CLUBS, SOCIETIES, ACTIVITIES and FACILITIES (2 of 4)

**SURGERY.** The Wolds Surgery in Tetford is open from 8am to 6.30pm Monday to Friday; closed weekends and bank holidays. The surgery is part of the East Lindsey Medical Group (ELMG), Newmarket, Louth Tel. **01507 603121** (**Option 1** Automated system to book, set or cancel appointments/order repeat prescriptions **Option 2** Care Navigation Team **Option 3** Pharmacy/Prescriptions 9am to 1pm and 2pm to 4pm). Dial 999 for life-threatening emergencies. There is a doctor in the practice at least 4 days a week and extra cover is provided by the advanced nurse practitioners. The practice has a Care Coordinator, who in liaison with the hospital can help patients in need to access services such as Macmillan, physio, medication, and has links with the disability nurse. There is a Veteran's liaison and a digital liaison person.

**PRIVATE GP CLINIC** A new private practice is up and running in Louth, a 20 minute appointment is £120, any forward treatments can be continued privately or referred back to the NHS.

The **online** ordering system (mainly for blood or smear tests, ordering repeat prescriptions and viewing your medical record), is at <https://systmonline.tpp-uk.com>. You will need to register with the surgery before you can log into this online system.

**Also** there is an app – 'Airmid' – which "provides you with existing SystmOnline functionality plus lots more." You can log in with your SystmOnline username and password. However it has received very poor reviews with one reviewer judging it as "about as useful as a trap door in a canoe."

You can also download the **NHS App** which enables you to

- Order repeat prescriptions.
- Book nurse and health care assistant appointments.
- View medical records.
- Access test results and hospital letters.

The main difference between the **SystmOnline** and the **NHS App** is that the NHS App provides access to hospital letters.

The old separate Wolds **pharmacy** number **01507 535001** will now take you to the same options as the surgery number. The pharmacy is Option 3 but the availability of the option to request repeat prescriptions over the phone is under review. The pharmacy is open for collection of medicines from 9am to 2pm & 4pm to 6pm Monday or 9am – 6pm Tuesday -Friday. Controlled drugs must be collected before 5pm.

**The ELMG website is at** <http://www.eastlindseymedicalgroup.nhs.uk/>. The new 'total triage' system is accessed here. Search on 'East Lindsey Medical Group' and select 'Appointments' then you have various options including 'Use our online form' which takes you to 'Medical request/New condition' which takes you into the triage. Operates from 8am to 1pm.



## CLUBS, SOCIETIES, ACTIVITIES and FACILITIES (3 of 4)

**The Wolds Surgery Patient Participation Group (PPG)** represents patients and ELMG medical staff of the Wolds Surgery Tetford and is scheduled to meet every two months and to deliver a regular Newsletter. Reports from the meetings are, when available, printed in this magazine.

Minutes/Notes from the meetings can be found on the **East Lindsey Medical Group database** under **Online Services/Get involved**: i.e. <https://www.eastlindseymedicalgroup.nhs.uk/get-involved/patient-group/>. If you wish to correspond with the PPG contact the Practice Manager Mickaela Crane at [licb.c83056@nhs.net](mailto:licb.c83056@nhs.net), or call the ELMG (East Lindsey Medical Group) switchboard on 01507 603121 or leave your correspondence at reception or with any PPG Member (names are on the Notes).

**‘LIVES’ First Responders.** For cardiac arrests, phone 999 and report the incident. You will be given a code for either the DEFIBRILLATOR on the Wolds surgery outside wall or on the village hall outside wall by the front door. Follow the instructions and close the defibrillator door (to stop the alarm). An ambulance will have been despatched and a LIVES First Responder alerted.

### LOCAL DEFIBRILLATORS:-

Tetford      Hamilton Hall and the Wolds Surgery *NB. If a defibrillator is used please alert Councillor Julia Larder on 07852 877425 as soon as possible after the event to ensure the necessary used items are replaced.*

Brinkhill      The porch of St Philip’s Church  
Langton      Langton village hall  
Raithby      Red Telephone Box, Raithby Road  
Somersby      Somersby Farm Office

**SOUTH WOLDS NURSING HOME** is offering tea and sandwiches to those who need a bit of company. They also offer, at cost, their chiropody and hairdressing services and will order milk in for you. Contact Linzy Stockdale on 01507 533393

**NEWSPAPERS** The nearest newspapers are at the Shell garage this side of Horncastle, but they sell out early (they don’t get many in of some titles). Later in the day it’s safer to go to Perkins newsagent in the centre of Horncastle or one of the supermarkets

**EDWARD RICHARDSON PRIMARY SCHOOL** Head Teacher Mr Stuart Spendlow. Contact: [enquiries@edward-richardson.lincs.sch.uk](mailto:enquiries@edward-richardson.lincs.sch.uk) Tel. 01507 533686  
<https://www.edward-richardson.lincs.sch.uk/index.html>

**MILK** is once again being delivered to Tetford, this time by McQueens Dairies who now have a milk round that includes Tetford. They make weekly deliveries on a Monday and Thursday. You can alter your order online and pay via direct debit.  
Tel. 0330 555 5588; website [www.mcqueensdairies.co.uk](http://www.mcqueensdairies.co.uk).

**POSTBOX COLLECTIONS** in Tetford and Salmonby are 9am weekdays and 7am Saturdays from all four postboxes.

## CLUBS, SOCIETIES, ACTIVITIES and FACILITIES (4 of 4)

**BUS SERVICE 24** between Horncastle and Louth. Bus stop at St Mary's Church, Tetford. 30mins to Louth, 20mins to Horncastle. No Sunday service. **Tel. 0345 234 3344; <https://lincsbuses.info>**  
Louth to Horncastle **Mon-Fri** 09.27; 11.57; 13.57. **Sat** 10.17; 13.47 in Tetford  
Horncastle to Louth **Mon-Fri** 10.13; 12.43; 14.43. **Sat** 11.00; 14.30 in Tetford  
Buses leave Horncastle Interchange Shelter at 09.50, 12.20 and 14.20 **Mon-Fri** and 10.40 and 14.10 **Saturdays**

Buses leave Louth Bus Station at 09.00, 11.30 and 13.30 **Mon-Fri** and 09.50 and 13.20 **Saturdays**  
Buses leave Louth Hospital at 10.40 and 13.10 **Mon-Fri**, connecting (sort of) at the Bus Station

There is also a CALLconnect On Demand Bus Service, subject to availability and within a radius of 12 miles (from Louth or Horncastle). You can book by app or by phone at one hours notice or up to 7 days in advance. It costs a maximum of £2 per single journey and can pick you up near your location. It is available to anyone and concessionary bus passes are accepted. The service operates 6 days a week, Monday to Saturday excluding Bank Holidays. Journeys are available to be booked from 7am to 7pm Monday to Friday and 8am to 6pm on Saturdays <https://lincsbuses.info/callconnect/more-information/>

**HORNCASTLE POST OFFICE and DELIVERY OFFICE** These are two separate operations, even though they occupy the same building. So if you've missed a delivery you go to the Delivery Office, but to click and collect you go to the Post Office counter. The following opening times may change without notice, especially during pandemics:

**The Post Office** is open 09.00-17.30 Mon to Fri and 09.00-13.30 Saturday.  
<https://www.postoffice.co.uk/branch-finder/1543245/horncastle>; Tel. 01507 523 520.

**The Delivery Office** is open 08.00-10.00 Mon, Tue, Wed, Fri; 08.00-10.00 & 16.00-19.00 Thursday and 08.00-12.00 Saturday. <https://www.localmint.com/uk/royal-mail-delivery-office-horncastle-hours-615198>;  
Tel.0345 774 0740

**RUBBISH and RECYCLING** collections are on a MONDAY. Household waste (black bins) every two weeks. PURPLE-LIDDED BINS (FOR RECYCLING DRY PAPER AND CARDBOARD) and GREY BINS (other recycling INCLUDING GLASS BOTTLES AND JARS) alternate every two weeks on non-household weeks (so purple and grey are collected every 4 weeks each). Green waste (green bins) Tetford Friday, but Salmonby Monday, of purple or grey recycling weeks (reducing December to March). Apply to East Lindsey District Council for a collections calendar and, if required, a green waste bin (**£52.50 per year**). Ensure bins are available from 5.30am on the morning of your collection.

<https://www.e-lindsey.gov.uk/article/6714/Refuse-Recycling-and-Green-Waste-Collection-Days>

### INTERNET TETFORD INFORMATION SITES

|                                               |                                                                                                                              |
|-----------------------------------------------|------------------------------------------------------------------------------------------------------------------------------|
| Tetford & Salmonby Community                  | <a href="http://www.facebook.com/tetfordlincolnshire/">www.facebook.com/tetfordlincolnshire/</a>                             |
| Tetford Matters                               | <a href="http://www.facebook.com/groups/160817426092384/">www.facebook.com/groups/160817426092384/</a>                       |
| Tetford Area Community                        | <a href="http://www.facebook.com/groups/tetfordareacommunity/">www.facebook.com/groups/tetfordareacommunity/</a>             |
| Tetford & Salmonby Recreation Ground          | <a href="http://www.facebook.com/TetfordandSalmonbyRecreationGround">www.facebook.com/TetfordandSalmonbyRecreationGround</a> |
| Tetford Area Crimewatch                       | <a href="http://www.facebook.com/groups/189857514689064/">www.facebook.com/groups/189857514689064/</a>                       |
| Tetford Parish Council                        | <a href="https://tetford.parish.lincolnshire.gov.uk">https://tetford.parish.lincolnshire.gov.uk</a>                          |
| NextDoor                                      | <a href="https://nextdoor.co.uk/">https://nextdoor.co.uk/</a>                                                                |
| Tetford and Surrounding Area Buying & Selling | <a href="http://www.facebook.com/groups/169398526795061/">www.facebook.com/groups/169398526795061/</a>                       |
| Tetford Memories                              | <a href="http://www.facebook.com/groups/Tetford/">www.facebook.com/groups/Tetford/</a>                                       |
| East Lindsey District Council                 | <a href="http://www.e-lindsey.gov.uk">www.e-lindsey.gov.uk</a>                                                               |
| Tetford & District Flower & Veg Show          | <a href="mailto:tetfordflowerandvegshow@gmail.com">tetfordflowerandvegshow@gmail.com</a>                                     |

## **TETFORD & SALMONBY PARISH COUNCIL** *by the Editor*

The Parish Council for Tetford and Salmonby consists of up to seven local elected members plus the Parish Clerk, who usually meet on the 2<sup>nd</sup> Wednesday of each month in the Hamilton Hall, Tetford at 7.30pm. Members of the public are welcome. Meeting agendas and official minutes are published on the Parish Council website: <https://tetford.parish.lincolnshire.gov.uk> or specifically <https://tetford.parish.lincolnshire.gov.uk/downloads/download/34/minutes-2024---2025> and on the Parish Council noticeboard outside the Hamilton Hall (take your reading specs and possibly a ladder). Parish Clerk Pauline Murray email: [clerk@tetfordparishcouncil.gov.uk](mailto:clerk@tetfordparishcouncil.gov.uk)

**The next Parish Council meeting will be held on Thursday 20<sup>th</sup>  
November 7.30pm in the Hamilton Hall.**

Your Parish Councillors are:

|                     |                                                                                                                                                                         |
|---------------------|-------------------------------------------------------------------------------------------------------------------------------------------------------------------------|
| Ray Whitley (Chair) | Manor Farm, East Road, Tetford, LN9 6QQ Tel. 07831 236766<br><a href="mailto:ray.whitley@tetfordparishcouncil.gov.uk">ray.whitley@tetfordparishcouncil.gov.uk</a>       |
| Julia Larder        | Hill View, North Road, Tetford, LN9 6QH. Tel. 07852 877425<br><a href="mailto:julia.larder@tetfordparishcouncil.gov.uk">julia.larder@tetfordparishcouncil.gov.uk</a>    |
| Don Osborne         | Rye Fields, South Ormsby Road, Tetford, LN9 6QF<br><a href="mailto:don.osborne@tetfordparishcouncil.gov.uk">don.osborne@tetfordparishcouncil.gov.uk</a>                 |
| Richard Hazel       | The Grange, Fulletby Road, Salmonby LN9 6QS<br><a href="mailto:richard.hazel@tetfordparishcouncil.gov.uk">richard.hazel@tetfordparishcouncil.gov.uk</a>                 |
| Bryan Willson       | Brook House Farm, Church Lane, Little London, Tetford email<br><a href="mailto:bryan.willson@tetfordparishcouncil.gov.uk">bryan.willson@tetfordparishcouncil.gov.uk</a> |

## **PARISH COUNCILLORS NEEDED!!**

**Please help us to keep our village a lovely place to live!**

**Join us on the Parish Council**

**We are a friendly bunch who could really do with some help!**

**We are two parish councillors down – could you spare us a few hours?**



**Email:-**

**[clerk@tetfordparishcouncil.gov.uk](mailto:clerk@tetfordparishcouncil.gov.uk)**

**or ring 07859 901835**

## TETFORD & SALMONBY CONTACTS

|                                                                                |                                                                                          |                              |
|--------------------------------------------------------------------------------|------------------------------------------------------------------------------------------|------------------------------|
| ELMG Wolds & Newmarket Surgeries                                               |                                                                                          | 01507 603121                 |
| Wolds Pharmacy                                                                 |                                                                                          | 01507 535001<br>Option (3)   |
| Defibrillator & cardiac emergencies                                            |                                                                                          | 999                          |
| 'LIVES' Enquiries                                                              | Parish Councillor Julia Larder-Sargent<br>Lives HQ                                       | 07852 877425<br>01507 525999 |
| Patient Participation Group (PPG)                                              | Marlene Renshaw                                                                          | 07795 662007                 |
| South Wold Nursing Home                                                        |                                                                                          | 01507 533393                 |
| Edward Richardson Primary School                                               | Reception                                                                                | 01507 533686                 |
| St. Mary's Church, Tetford<br>Churchwardens                                    | Marlene Renshaw<br>Julia Larder-Sargent                                                  | 07795 662007<br>07852 877425 |
| W.I. President                                                                 | Terri Willings                                                                           | 01790 612341                 |
| Hamilton Hall                                                                  | Marlene Renshaw                                                                          | 07795 662007                 |
| Tea & Chat                                                                     | Marlene Renshaw                                                                          | 07795 662007                 |
| Short Mat Bowls                                                                | David Needs                                                                              | 01507 533705                 |
| Table Tennis                                                                   | tetfordtabletennisclub@gmail.com                                                         |                              |
| Pilates                                                                        | debbiejenner@outlook.com                                                                 |                              |
| Pilates & Wellbeing                                                            | Pilatinas8@gmail.com<br>www.pilatinas.com                                                | 07896779958                  |
| Tetford Feral Writers                                                          | Stephanie Wilkinson                                                                      | 07725 058959                 |
| Reading Group                                                                  | kwatkinshmg@gmail.com                                                                    |                              |
| Recreation Ground                                                              | Alison Sparks, secretary<br>alisparks@sky.com                                            | 01507 534384                 |
| Tetford Walking Group                                                          | jontywild@byacatswhisker.co.uk                                                           |                              |
| Parish Council (Clerk)<br>Mrs Pauline Murray                                   | <a href="mailto:clerk@tetfordparishcouncil.gov.uk">clerk@tetfordparishcouncil.gov.uk</a> |                              |
| East Lindsey District Council                                                  |                                                                                          | 01507 601111                 |
| Tetford & Donington District Councillor<br>Daniel Simpson                      | daniel.simpson@e-lindsey.gov.uk                                                          |                              |
| Louth Wolds County Councillor                                                  | cllra.mcgonigle@lincolnshire.gov.uk                                                      |                              |
| Lincolnshire County Council                                                    |                                                                                          | 01522-552222                 |
| White Hart                                                                     | Nikki Stockdale                                                                          | 01507 533255                 |
| The Times of Tetford & Salmonby                                                | thetimesoftetford@gmail.com                                                              | 01507 534800<br>07789 485339 |
| East Lindsey Library Service                                                   |                                                                                          | 01522 782010                 |
| Access Mobile Library Delivery<br>Service                                      | graham.owen@gll.org                                                                      | 07483 017085                 |
| The Mansion House Honesty Shop                                                 | Outside The Mansion House LN9 6QL                                                        | N/A                          |
| Locksmith                                                                      |                                                                                          | 07847 849202                 |
| Horncastle Police Station                                                      |                                                                                          | 01507 523332                 |
| Pilgrim Hospital, Boston                                                       |                                                                                          | 01205 364801                 |
| Louth Hospital                                                                 |                                                                                          | 01507 600100                 |
| Grimsby Hospital                                                               |                                                                                          | 01472 874111                 |
| Lincoln County Hospital                                                        |                                                                                          | 01522 512512                 |
| Anglian Water                                                                  |                                                                                          | 01522 341000                 |
| Victoria Atkins MP                                                             | Victoria@victoriaatkins.org.uk                                                           | 020 7219 5897                |
| Horncastle Covid-19 CRISIS                                                     |                                                                                          | 07395 905 352                |
| CALLCONNECT                                                                    | <a href="https://lincsbus.info/callconnect/">https://lincsbus.info/callconnect/</a>      | 0345 234 3344                |
| Louth Riverhead Theatre Box Office                                             | <a href="http://www.louthriverheadtheatre.com">www.louthriverheadtheatre.com</a>         | 01507 600350                 |
| Horncastle Theatre Company                                                     | <a href="https://www.horncastletheatre.co.uk/">https://www.horncastletheatre.co.uk/</a>  |                              |
| Non-Emergency Calls to Police                                                  |                                                                                          | 101                          |
| Life-threatening medical and other emergencies                                 |                                                                                          | 999                          |
| Urgent and Non-Emergency Health Issues Advice Line                             |                                                                                          | 111                          |
| Emergency Ambulance                                                            |                                                                                          | 112                          |
| Electricity Emergency Service – reporting electricity emergencies & power cuts |                                                                                          | 105                          |
| National Gas Emergency Service – reporting gas leaks & emergencies             |                                                                                          | 0800 111 999                 |
| Water Emergencies – reporting water leaks & emergencies                        |                                                                                          | 0800 783 4444                |
| National Floodline                                                             |                                                                                          | 0345 988 1188                |
| Environmental Incident Hotline – reporting environmental incidents             |                                                                                          | 0800 807060                  |
| Horncastle Community Fire Station/ Spilsby Fire Station (central number)       |                                                                                          | 01522 555777                 |

## **UNCLASSIFIED ADS**

**Dean Wilkinson Decorating Services.** All types of painting and wallpapering. Based in Tetford, friendly advice and free estimates available. Call 07584 679744 or email [deanwilk28@gmail.com](mailto:deanwilk28@gmail.com).

**Mowers serviced.** All makes & models. Repairs undertaken. Collection service. Competitively priced. Phone Chris on 07934 467270

**D.G.S. Quality Second Hand Furniture.** Church Lane, Hagworthingham PE23 4LP. Also large bags of sticks for kindling.

**Complete Cleaning & Housekeeping Service.** Occasional one-off clean-up or regular visits. References available. Phone Steph on 07929 860397.

**Professional Pest Control.** LINCSPEST LTD. Rats, mice, flies, fleas, ants, moles wasps. Call 01507 816001; 01526 333108; 01522 626002; 01790 752825. Freephone 0800 234 3602. Louth, Horncastle, Woodhall Spa, Market Rasen & all surrounding areas. [www.lincspest.co.uk](http://www.lincspest.co.uk). Discreet unmarked vehicles.

**Art Classes. Oxcombe Arts.** Thursdays 1-4pm. Tel. 07765 992770.

[www.oxcombepottery.co.uk](http://www.oxcombepottery.co.uk)

Email [enquiries@oxcombepottery.co.uk](mailto:enquiries@oxcombepottery.co.uk)

**Indian Ready Meals. Yellowbelly kitchen,** Fulletby. Pre-order or visit.

[www.yellowbellykitchen.co.uk](http://www.yellowbellykitchen.co.uk)

Tel. 07939 902162.

**Garden Machinery. J.V. Services,** Beck House, Salmonby. Servicing & repairs; classic & vintage tractor repairs, servicing & restoration help; experienced in classic cars. 45 years in motor trade. Ring 07803 003047 or 01507 533511.

**Havenfield Pet Foods.** Free delivery. Email [havenfieldfoods@btinternet.com](mailto:havenfieldfoods@btinternet.com). Tel. 01507 533338.

Mob. 07733 416495. [www.havenfieldpetfoods.co.uk](http://www.havenfieldpetfoods.co.uk)

**Garment Alteration & Repairs.** Soft furnishings. Upholstery renovation. Ring Beryl Baker on 07984 066881.

Email [stitchedup.sewwhat@gmail.com](mailto:stitchedup.sewwhat@gmail.com)

**Campbell Brothers Painting & Decorating.** Indoor & Outdoor. Gutter cleaning. Family run. Mob. 07388 051594. Email [campbellbrotherspds@gmail.com](mailto:campbellbrotherspds@gmail.com)





Choir of the Earth in Vienna

I had the most thrilling and thoroughly enjoyable trip to Vienna recently to sing Haydn's 'Missa in Angustilis' or 'Mass for troubled times' in the resplendent Esterhazy Palace where Haydn spent many years composing and performing his work. He wrote the Mass in 1798 when the world was in turmoil and Napoleon and his French forces were waging war against Austria. Then on the 15<sup>th</sup> September, the day of the very first performance, it was learned that Napoleon had been defeated by a British fleet led by Horatio Nelson at the Battle of the Nile in August 1798. The Mass was thereafter known as the Nelson Mass.

It was a wonderful and moving experience to sing such a memorable piece in the Haydnssaal or Haydn Hall, renowned for its unique acoustics and atmosphere. Choir, soloists and orchestra, led by Ben England BEM, made a truly impressive sound, acknowledged by rapturous applause. It called for an encore, of course, and we sang 'The Heavens Are Telling' from Haydn's The Creation. A considerable amount of online rehearsing had taken place prior to our arriving in Vienna, followed by two days' rehearsals with Ben and his wife Ana accompanying. The online practices via video links were tantamount to the success of our overall performance, and it meant that singers from all over the world – Australia, New Zealand, Canada, USA and Europe, could come together in such an exciting and unforgettable way.

With a few days remaining before our flight home, my friend and I went to a wonderful concert of the Vienna Boys' Choir; a Vivaldi Four Seasons concert in the grand and glorious St Stephen's Cathedral and an enjoyable two hour cruise on the River Danube.

Choir of the Earth's next concert is in Leipzig in 2026. I may well be there!

*Kath Thomas*